

# 2025 Parent and Student Handbook

## Scholarship Program

**American Association of Blacks in Energy**  
1625 K Street, NW, Suite 405, Washington, DC 20006  
202-371-9530 \* [info@aabe.org](mailto:info@aabe.org) \* [www.aabe.org](http://www.aabe.org)



## Table of Contents

Purpose .....	3
Eligibility .....	3
Selection .....	3
Awards .....	3
The Application Package.....	4
Renewing Scholarship Eligibility .....	7
Scholarship Awarding Procedure and Payments.....	7
Loss of Renewable Scholarship .....	8
Change of Contact Information for Award Recipients .....	8
Questions? .....	8
Scholarship Application Checklist.....	9



## FLORIDA CHAPTER 2025 SCHOLARSHIP APPLICATION GUIDELINES

### **Purpose**

The American Association of Blacks in Energy is a professional association composed of African Americans in the energy industry. Through its Scholarship Program, the Association seeks to help increase the number of African Americans, Hispanics, and Native Americans (underrepresented minorities) in energy related fields. By doing so, we help our nation address a critical need and a challenge to our future economic vitality in the world market.

### **Eligibility**

**Candidates for an AABE scholarship must meet the following five (5) eligibility criteria (6<sup>th</sup> criteria is optional):**

1. The student must have a minimum GPA of 3.0 on a 4.0 scale.
2. Be a graduating high school senior who has applied to one or more accredited colleges/universities.
3. Plan to major in business, one of the physical sciences, technology, engineering, or mathematics fields in preparation for a career in the energy sector.  
Example majors include but are not limited to the following academic disciplines with an intent to major in energy related sectors (majors in red are awarded 10 bonus points):
  - *Business*: business administration, accounting, finance
  - *Physical Sciences*: chemistry, geology, metallurgy, nuclear physics, physics
  - *Technology*: computer science
  - *Engineering*: aerospace, automotive, chemical, civil, computer, construction, electrical, environmental, industrial & systems, materials, mechanical, metallurgical, nuclear, petroleum, power, software
  - *Mathematics*: applied mathematics, mathematics
4. The student must be one of the underrepresented minorities (African American, Hispanic or Native American).
5. If applying for any Florida Chapter scholarships, is a Florida resident or resides in an area where the Florida Chapter is the nearest AABE chapter.
6. If applying for the Florida Chapter need-based scholarship, exhibits financial need and meets all other eligibility criteria. (Financial need is not a consideration for other Florida Chapter, regional, and national awards.)

*Applications received from those who do not meet the eligibility criteria above will not be considered. Candidates may not apply for scholarships with more than one local chapter.*

### **Selection**

Scholarship recipients - known as AABE Scholars - are determined each spring by the organization's local chapter scholarship committee for local scholarships and by the National Scholarship Committee for national and regional scholarships. Recipients of a Florida Chapter scholarship will receive notification of their selection by e-mail and/or phone. National and regional winners will be notified through methods determined by the National Office.

### **Awards**

The Florida Chapter of AABE will award multiple scholarships to graduating high school seniors. Florida Chapter award amounts are usually \$250 to \$2,500 but may vary from year to year. Select local chapter applications are forwarded to compete for a Southeast Regional Award of \$3,000. (The Southeast Region is one of six AABE Regions). Additionally, a Rufus D. Gladney Premier Award of \$5,000 is given annually for a maximum of four years to the candidate who is judged to demonstrate the most outstanding achievement and promise. This is a national award. National and regional awards are distributed to the students upon presentation of proof of enrollment at an accredited college or university. Distribution of local chapter awards is done by the local chapter upon proof of enrollment at an accredited college or university.

**Additionally**, AABE Florida Chapter High School award winners will be given the opportunity to apply for an annual continuing collegiate "AABE FL Scholars" scholarship based on certain criteria as outlined in a separate document (AABE FL Scholar Application). The AABE FL Scholar Application document will be sent out to our High School Award recipients annually up to the 4<sup>th</sup> year after their high school graduation year. The continuing scholarship award amount is usually \$250 to \$1,000 and can vary based on AABE Florida Chapter procurement.



## The Application Package

Consideration will be given only to candidates submitting complete online application packages to <https://aabescholarship.awardspring.com/Home/Scholarships>. A complete online application package will consist of:

1. Completed online AABE application form. Please fill out all required questions as indicated on the online application.
2. Make sure to apply through the AABE Florida Chapter Scholarship website linked above and shown below.

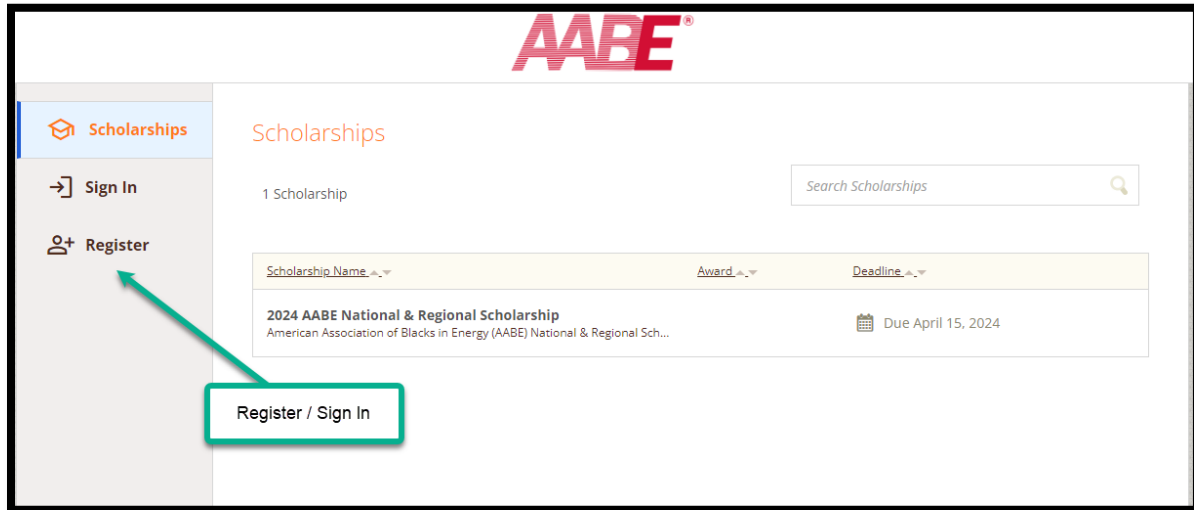

3. On the bottom of the first, click **"Apply"** to start.

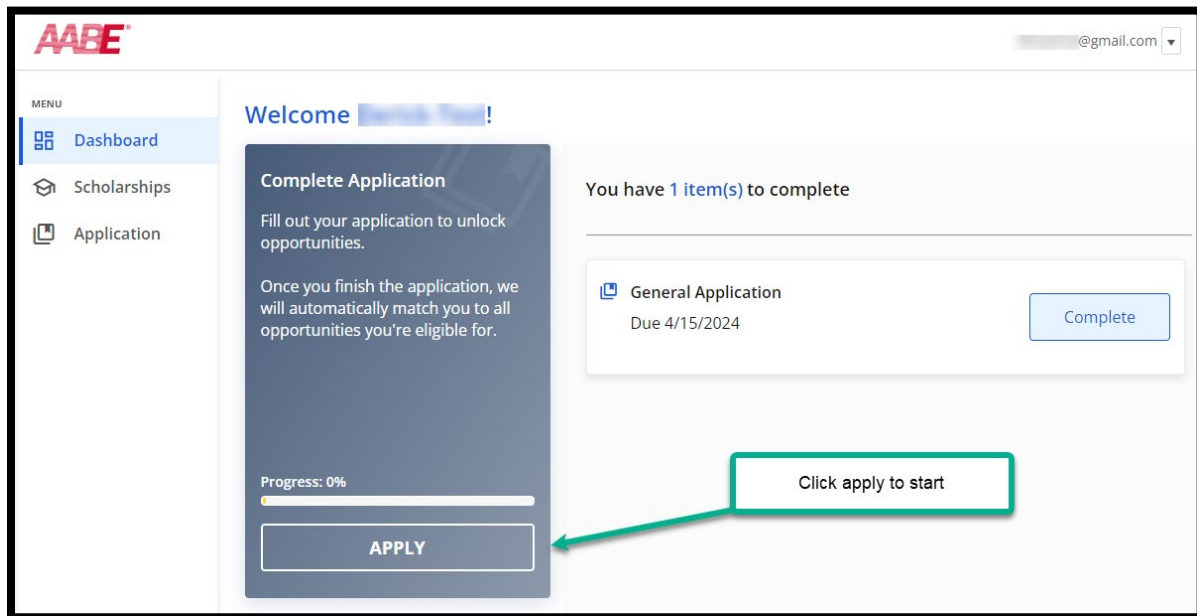

4. As you navigate through the screens, don't forget to select "AABE Florida Chapter" as shown below:

The screenshot shows a portion of an application form. On the left, a teal-bordered box contains the text: "In the Student Information section select the AABE Florida Chapter for your local AABE Chapter". An arrow points from this box to a dropdown menu. The form has a light orange background for the ethnicity and underrepresented groups sections.

What is your ethnicity? (optional)

- African-American
- Hispanic
- Native American
- Choose not to respond
- Not Listed

There are many local chapters that belong to the American Association of Blacks in Energy (AABE), at times there may be more than one chapter per state. Please use the following link to assist you in determining the local chapter most relevant to you. [AABE Chapters List](#)

Please select your local AABE chapter listed below, based on your current high school residency.

AABE Florida Chapter

Are you a part of one or more of the underrepresented groups?

- African American
- Hispanic
- Native American

5. Official High School transcript needs to be uploaded under the Academic Information, see below:

The screenshot shows the "Application for" form with a sidebar on the left. The sidebar includes sections for "Student Information" (Completed), "Parent(s) or Legal Guardian Information" (Completed), "Academic Information" (In Progress), "Student Activities", and "Essay". The "Academic Information" section is highlighted in orange. A teal-bordered box on the left contains the text: "In the Academic Information section upload your official transcript." An arrow points from this box to an "Upload File" button.

Application for **Enrollment**

**Student Information**  
*Completed*

**Parent(s) or Legal Guardian Information**  
*Completed*

**Academic Information**  
*In Progress*

**Student Activities**

**Essay**

What is your current Academic Status?

- Graduating High School Senior
- Current College Student

What is your most recent GPA?

Please upload official transcript documenting most recent GPA.

Upload File

Have you completed or are currently enrolled in any Honors, Advanced Placement (AP), or International Baccalaureate (IB) classes in high school?

- Yes
- No

What type of degree are you pursuing?

- Certificate/Vocational Technical

6. Official proof of ACT or SAT scores (screenshot/picture from College Board account showing your name is acceptable) will be uploaded on the online application as shown below. Students are now able to submit their ACT scores electronically using the following AABE ACT College Code: **8182**.

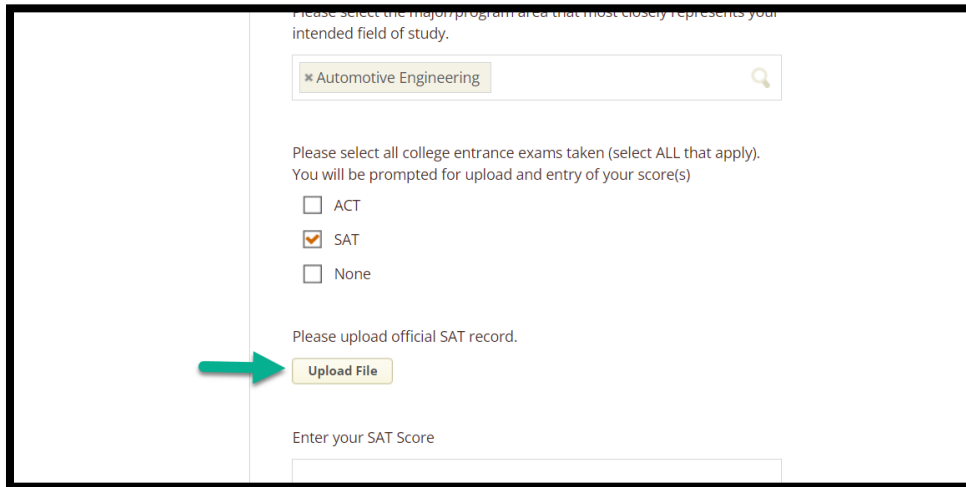

Please select the major/program area that most closely represents your intended field of study.

✖ Automotive Engineering

Please select all college entrance exams taken (select ALL that apply). You will be prompted for upload and entry of your score(s)

ACT  
 SAT  
 None

Please upload official SAT record.

**Upload File**

Enter your SAT Score

7. A complete essay that has been proofread for typing error, grammar, structure, organization, content and clarity will be entered on the online application as shown below. The essay question will be shown on the online application.

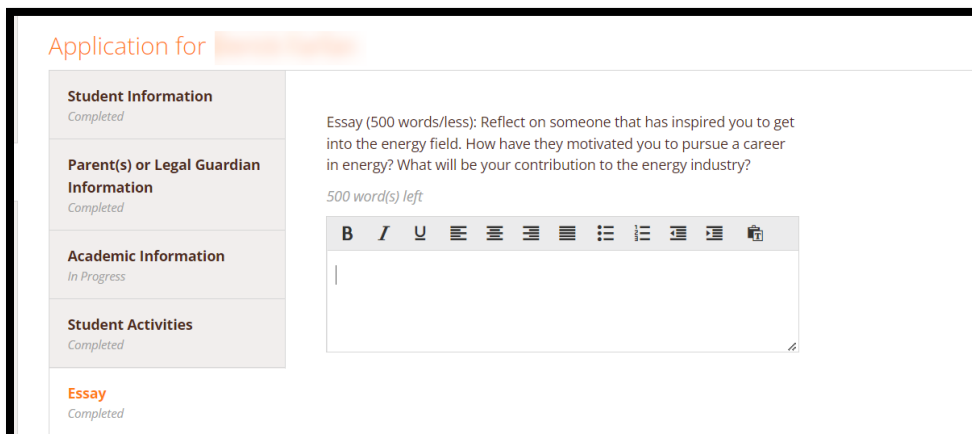

Application for [redacted]

**Student Information**  
Completed

**Parent(s) or Legal Guardian Information**  
Completed

**Academic Information**  
In Progress

**Student Activities**  
Completed

**Essay**  
Completed

Essay (500 words/less): Reflect on someone that has inspired you to get into the energy field. How have they motivated you to pursue a career in energy? What will be your contribution to the energy industry?

500 word(s) left

**B I U** [bulleted list icon] [numbered list icon] [indent icon] [outdent icon] [undo icon]

Complete application packages **MUST BE COMPLETED (SUBMITTED) NO LATER THAN APRIL 16, 2025** and submitted **ONLINE ONLY**. **PLEASE DO NOT SEND APPLICATIONS TO THE NATIONAL OFFICE COMMITTEE AS THEY WILL NOT BE CONSIDERED FOR SUPPORT.**



**Please remember that in applying and if accepting a scholarship, you have agreed on the application to the below statements in the Certification Signature Section.**

- ✓ I certify that the information provided on the application and all supporting documentation submitted at any time is true, correct and complete to the best of my knowledge. I understand that if I give information that is not true or if I withhold information and my student(s) receive a scholarship for which they are not eligible, the scholarship will be denied or revoked.
- ✓ I have an **unweighted** GPA of a minimum of 3.0 on a 4.0 scale without rounding.
- ✓ I am a graduating high school senior who intends to enroll next semester in an accredited college or university.
- ✓ I will major in business, one of the physical sciences, technology, engineering or mathematics fields as described in the guidelines on page 1.
- ✓ I am one of the underrepresented minorities (African American, Hispanic or Native American).
- ✓ I have submitted a complete (ONLINE ONLY) AABE application package as described by the section "The Application Package" shown on page 4 & 5. I understand that my application will not be considered if any of the required documentation is not submitted on-time or is incomplete.
- ✓ I have uploaded my official high school transcript as outlined in bullet point #4 on page 5. (Note: Please provide proof of the **unweighted GPA** to be included in transcripts).
- ✓ I have uploaded my official SAT/ACT scores as outlined in bullet number 5 on page 5.
- ✓ I have composed the requested essay and it has been proofread for typing errors, grammar, structure, organization, content and clarity.
- ✓ I have entered all my school and community extracurricular activities.
- ✓ My name appears on ALL submitted supporting documents.

**Renewing Scholarship Eligibility**

The Rufus D. Gladney National Scholarship is renewable for up to four years. To receive the next installment, all three (3) of the following requirements must be met:

1. The student must maintain an academic average of 3.0 or better.
2. The student must have completed a minimum of 2 semesters prior to requesting the next installment.
3. The student's major must be in business or one of the physical sciences, technology, engineering or mathematics fields.

**Scholarship Awarding Procedure and Payments**

National Awards are made to the students upon presentation of proof of enrollment at an accredited college or university at the discretion of the National Office. Distribution of local chapter awards are made at the discretion of the local chapter upon proof of enrollment at an accredited college or university. The check will be made payable in the student's name.



### **Loss of Renewable Scholarship**

The Rufus D. Gladney Scholarship will not be renewed if any of the following circumstances occur:

1. Student does not complete two (2) concurrent semesters.
2. Student withdraws from school.
3. Student changes majors to an uncovered field of study.
4. Student does not maintain a 3.0 grade average.

### **Change of Contact Information for Award Recipients**

If there is a change of address, telephone, cell phone or e-mail address, the student must immediately notify the Association by email at: [scholarship@aabefl.org](mailto:scholarship@aabefl.org).

### **Questions?**

For Florida Chapter specific scholarship questions, reach out to the AABE Florida Chapter Scholarship Chair: Derick Farfan | [scholarship@aabefl.org](mailto:scholarship@aabefl.org).





## American Association of Blacks in Energy - Florida Chapter

### Scholarship Application Checklist

The following is a list of qualifications and items that **MUST** be submitted for your scholarship application to be considered. Every candidate must be able to check each line, except where noted.

As a candidate for the AABE scholarship program, I affirm the following:

- I have an **unweighted GPA** of a minimum of 3.0 on a 4.0 scale without rounding.
- I am a graduating high school senior who intends to enroll to enroll next semester in an accredited college or university.
- I will major in business, one of the physical sciences, technology, engineering or mathematics fields as described in the guidelines on page 1.
- I am one of the underrepresented minorities (African American, Hispanic or Native American).
- I have submitted a complete (**ONLINE ONLY**) AABE application package as described by the section "The Application Package" shown on page 4 & 5. I understand that my application will not be considered if any of the required documentation is *not submitted on-time or is incomplete.*)
- I have uploaded my official high school transcript as outlined in bullet point #4 on page 5. (Note: Please provide proof of the unweighted GPA to be included in transcripts).
- I have composed the requested essay and it has been proofread for typing errors, grammar, structure, organization, content and clarity.
- I have entered all my school and community extracurricular activities.
- My name appears on ALL submitted supporting documents.